

SR28MR-3

Powerful, tough, durable and designed with value in mind

- ▶ Engine model: Shangchai C6121ZG16
- ▶ Rated power: 187 kW/2200 rpm
- ▶ Operating weight: 28.0 t

Product features

Designed for value durability and power specifically as a bulk waste management and landfill compactor, the 28-ton SR28MR-3 features four-wheel drive, torque converter, power shift transmission, stepless speed regulation and articulated frame. For operator productivity and safety, its dual cab comes standard with air conditioning, heating, air purification devices and even a CD stereo. Powered by a Shangchai C6121ZG16 engine.



Address: Unit 1 Jurgens Street Jet Park Ext 5- 1619

Tel: +27 (0) 11 390 8160

Website: <http://en.shantui.com>

SHANTUI
VALUE THAT WORKS

Fuelled By

EVERSTAR
Industries

SR28MR-3

Technical specifications:

Overall length: 7747 mm





Minimum turning radius: 7250 mm

Overall width: 3660 mm

Fuel capacity: 450 L

Overall height: 3960 mm

SR28MR-3

WEIGHT AND DIMENSIONS		Weights		Operating weight	28000 kg			
	WEIGHT AND DIMENSIONS	Weights	Axle load, front	14000 kg				
			Axle load, rear	14000 kg				
			Compaction characteristic		Static linear load, front/rear	618/762 N/cm		
		Working width	3520 mm					
		Drum diameter	1700 mm					
		Wheelbase	3500 mm					
BLADE		Maximum lifting height		1146 mm				
	BLADE	Maximum cutting depth		150 mm				
		Blade capacity		11 m ³				
ENGINE AND DRIVE TRAIN		Engine		Make & model		Shangchai C6121ZG16		
	ENGINE AND DRIVE TRAIN			Type		Turbocharged		
				Fuel		Diesel		
				Cooling		Water		
				Number of cylinders		6		
				Rated power		187 kW		
				Rated speed		2200 rpm		
				Minimum ground clearance		465 mm		
				Maximum climbing ability		100%		
				Forward speed		I	0~4.82 km/h	
						II	0~7.66 km/h	
				III	0~11.6 km/h			
		Reverse speed		I	0~4.82 km/h			
				II	0~7.66 km/h			
				III	-			
CABIN & CONTROLS		Brakes		Service brake		Pressurized air braking		
	CABIN & CONTROLS			Parking brake		Mechanical		
		Steering		Steering system		Oscillating, articulating		
				Steering method		Hydrostatic		
				Steering angle (Grad)		±36°		
				Oscillating angle (Grad)		±8°		

OVERALL DIMENSIONS

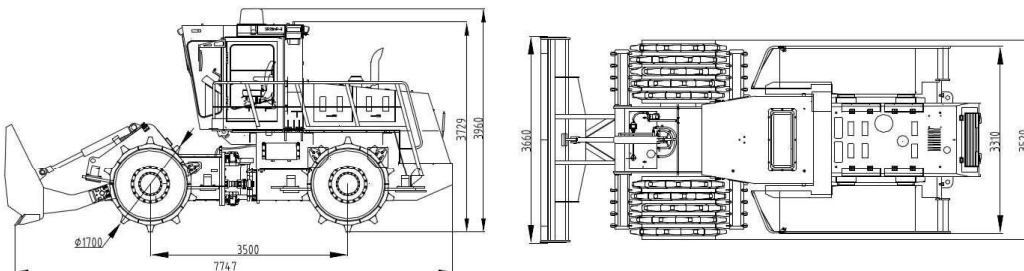

▶ THE SPECIFICATIONS ARE SUBJECT TO CHANGE WITHOUT NOTICE. THE PICTURES MAY INCLUDE OPTIONS. THE ACTUAL COLOR & APPEARANCE OF THE PRODUCT MAY DIFFER FROM WHAT IS SHOWN.